

# SHIMANO®

## SAHARA

### SH-GTE2500

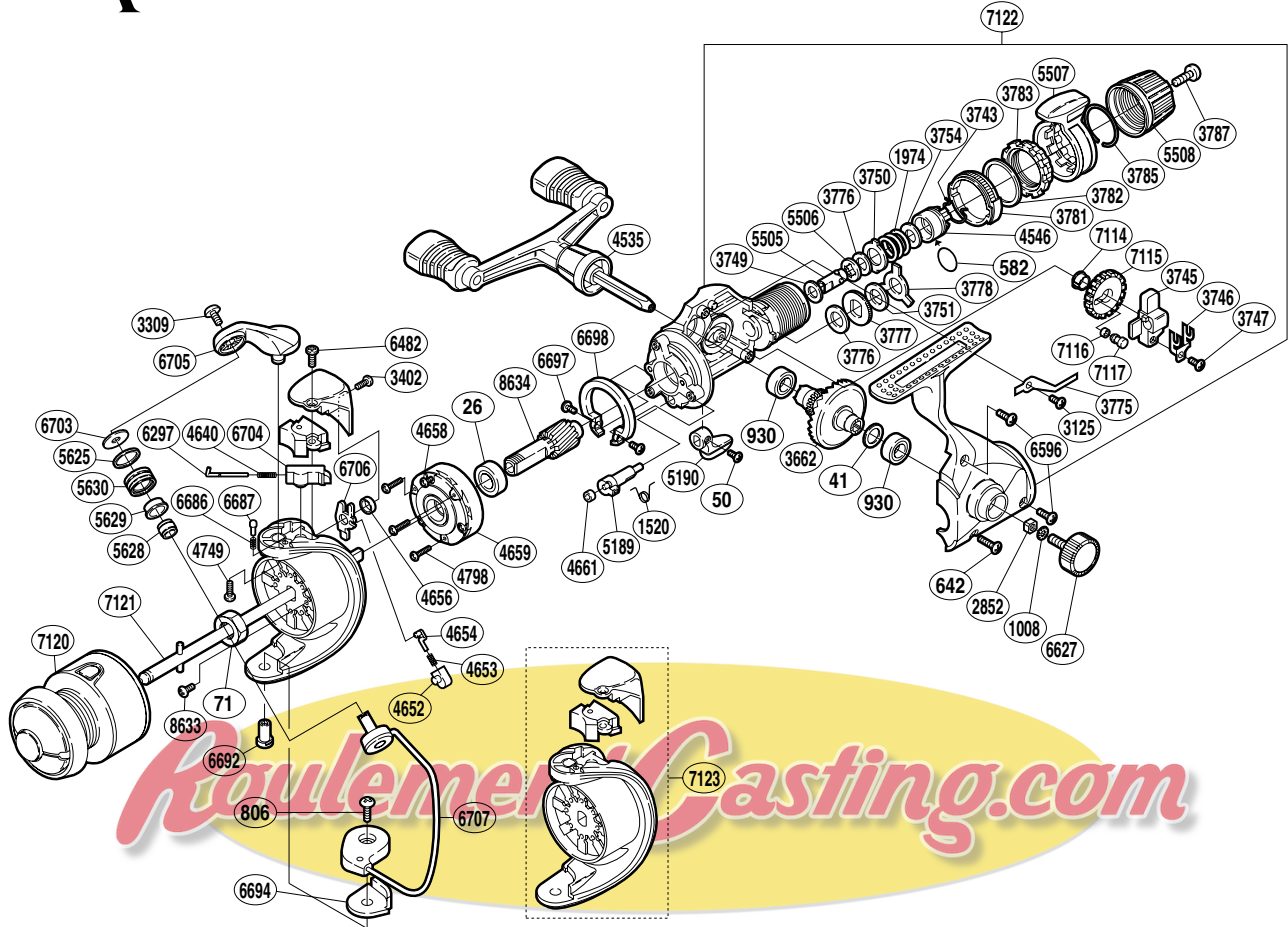

| Part No. | Description                   | Part No. | Description                    | Part No. | Description                   |
|----------|-------------------------------|----------|--------------------------------|----------|-------------------------------|
| RD 0026  | Ball Bearing                  | RD 3778  | Eared Washer "B"               | RD 5630  | Line Roller                   |
| RD 0041  | Drive Gear Washer             | RD 3781  | Lever Click Gear               | RD 6297  | Bail Spring Guide (A)         |
| RD 0050  | Anti-Reverse Lever Screw      | RD 3782  | Fightin' Pressure Screw Washer | RD 6482  | Rotor Protector Screw (large) |
| RD 0071  | Rotor Nut                     | RD 3783  | Fightin' Pressure Screw        | RD 6596  | Side Cover Screw (short)      |
| RD 0582  | "O" Ring                      | RD 3785  | Lever Hold Spring              | RD 6627  | Handle Screw Cap              |
| RD 0642  | Side Cover Screw (long)       | RD 3787  | Drag Programmer Screw          | RD 6686  | Click Spring                  |
| RD 0806  | Bail Hold Support Screw       | RD 4535  | Double Paddle Handle Assembly  | RD 6687  | Bail Arm Click                |
| RD 0930  | Ball Bearing                  | RD 4546  | Pressure Screw                 | RD 6692  | Bail Hold Support Shaft       |
| RD 1008  | Handle Lock Washer            | RD 4640  | Bail Spring                    | RD 6694  | Bail Hold Support Spacer      |
| RD 1520  | Anti-Reverse Cam Spring       | RD 4652  | Lever Spring Guide (B)         | RD 6697  | Friction Ring Screw           |
| RD 1974  | Drag Coil Spring              | RD 4653  | Lever Spring                   | RD 6698  | Friction Ring                 |
| RD 2852  | Handle Screw Lock             | RD 4654  | Lever Spring Guide (A)         | RD 6703  | Line Roller Washer            |
| RD 3125  | Drag Click Screw              | RD 4656  | Trip Lever Spacer              | RD 6704  | Bail Spring Guide (B)         |
| RD 3309  | Line Roller Screw             | RD 4658  | Clutch Cover Screw             | RD 6705  | Bail Arm                      |
| RD 3402  | Rotor Protector Screw (small) | RD 4659  | Roller Clutch Assembly         | RD 6706  | Bail Trip Lever               |
| RD 3662  | Drive Gear                    | RD 4661  | Anti-Reverse Cam Ring          | RD 6707  | Bail Assembly                 |
| RD 3743  | Hold Click Spring             | RD 4749  | Bail Arm Screw                 | RD 7114  | Oscillating Gear Bushing      |
| RD 3745  | Oscillating Slider            | RD 4798  | Roller Clutch Screw            | RD 7115  | Oscillating Gear              |
| RD 3746  | Oscillating Slider Retainer   | RD 5189  | Anti-Reverse Cam               | RD 7116  | Oscillating Guide Pin Bushing |
| RD 3747  | Slider Retainer Screw         | RD 5190  | Anti-Reverse Lever             | RD 7117  | Oscillating Guide Pin         |
| RD 3749  | Drag Washer "C" (white)       | RD 5505  | Drag Shaft (A)                 | RD 7120  | Spool Assembly                |
| RD 3750  | Eared Washer "B"              | RD 5506  | Drag Shaft (B)                 | RD 7121  | Main Shaft                    |
| RD 3751  | Drag Washer "C" (blue)        | RD 5507  | Fightin' Drag Lever            | RD 7122  | Body Assembly                 |
| RD 3754  | Drag Spring Washer            | RD 5508  | Drag Programmer                | RD 7123  | Rotor Assembly                |
| RD 3775  | Drag Click                    | RD 5625  | Line Roller Spacer             | RD 8633  | Nut Lock Screw                |
| RD 3776  | Drag Washer "C" (cloth)       | RD 5628  | Line Roller Collar             | RD 8634  | Pinion Gear (B)               |
| RD 3777  | Click Gear                    | RD 5629  | Line Roller Bushing            |          |                               |